

5.0 cu. ft. 27" WashCombo™ All-in-One Washer/Dryer

- 5.0 cu. ft. Mega Capacity
- Inverter HeatPump™ Technology
- TurboWash® 360° Technology
- AI Fabric Sensor / Smart Pairing™
- ezDispense® Automatic Dispenser
- 30 Cycles / 18 Options
- Allergiene® Cycle
- ColdWash™ Option
- Direct Drive Motor (10-Year Limited Warranty)
- NeveRust™ Stainless Steel Tub
- LG ThinQ® Technology (Wi-Fi)



Washer+Dryer
WashCombo™
All-in-One

COLOR AVAILABILITY

WM6998HVA – Graphite Steel

WM6998HBA – Black Steel

CAPACITY & MATCHING DRYERS

Capacity (cu. ft.) 5.0

Matching Electric Dryer N/A

Matching Gas Dryer N/A

APPEARANCE

Electronic Controls with LCD Display Yes

Hard Buttons No

Touch Buttons Yes

Dial-A-Cycle™ Yes

ENERGY & WATER

ENERGY STAR® Certified Yes

CEE Qualified Tier 2

Integrated Modified Energy Factor (IMEF) 2.92

Integrated Water Factor (IWF) 2.9

WASH CYCLES

Number of Cycles 30

Wash Cycles Wash+Dry, AI Wash+Dry, Normal, AI Wash, Bedding, Delicates, Towels, Quick Wash, Heavy Duty, Allergiene, Perm. Press, Dry Only, Delicates Dry, Perm. Press Dry, Tub Clean, Bright Whites, Sanitary, Rinse+Spin, Spin Only, Hand / Wool, Activewear, Swimwear, Kids Wear, Jeans, Dresses, Color Care, Sweat Stains, Small Load, Large Load, XL Load

WASH OPTIONS

Number of Options 18

Options TurboWash®, Steam, Fresh Care, Pre-wash, Remote Start, Delay Wash, Wi-Fi, Add Item, Extra Rinse, Control Lock, Drum Light, Cold Wash, Detergent Level, Softener Level, Signal, Cycle List Edit, Cycle Optimization, Softener Tank Use

WASH DETAILS

Internal Heater Yes

Number of Wash / Rinse Temps 5

Wash / Rinse Temps Extra Hot, Hot, Warm, Cold, Tap Cold

Number of Spin Speeds 5

Spin Speeds Extra High, High, Medium, Low, No Spin

Max RPM 1300

Water Levels Load Sensing

Number of Soil Levels 5

AAFA Certified Yes

DRYING DETAILS

Ventless Condensing Drying Yes

Automatic Dry Cycles Normal, Damp, Energy Saver

Time Drying 30 min, 60 min, 90 min, 120 min

Normal Drying Yes

Turbo Drying No

FABRIC CARE

AI DD™ Yes (2.0)

Wash Technology TurboWash® 360°

Steam Technology Yes

Allergiene® Cycle Yes

Sanitary Cycle Yes

ColdWash™ Option No

AI Fabric Sensor Yes

Soil Level Sensor Yes

CONVENIENCE

TrueBalance™ Anti-Vibration System	Yes
Dispenser Type	ezDispense® cartridge (Detergent, Softener), Main Wash, Bleach (cup)
Drum Light	Yes
End of Cycle Signal	Yes
LoadSense	Yes
Control Lock	Yes
Auto Suds Removal	Yes
Adjustable Leveling Legs	Yes
Auto Cleaning Condenser	Yes
ADA Compliant	No

SMART FEATURES

Wi-Fi Enabled	Yes
ThinQ® Technology	Yes
ThinQ Care	Yes
ThinQ Up	Yes
Voice Control	Google Assistant, Amazon Alexa
SmartDiagnosis™	Yes (3.0)
Remote Start (On / Off)	Yes
Remote Monitoring & Notifications	Yes
Energy Monitoring	Yes
Tub Clean Coach	Yes

MOTOR AND AGITATOR

Motor Type	Inverter Direct Drive Motor
Axis	Horizontal

MATERIALS AND FINISHES

NeveRust™ Stainless Steel Drum	Yes
Cabinet / Control Panel	Painted Steel (One unit)
Top Plate	Painted Steel
Door / Rim	Glass / Chrome
Door Cover	Tempered Glass Door

TECHNICAL SPECS

Electrical Requirements	120V, 60 hz, 12 Amps
Type	Electric
Power Outlet Location	Within 60" of Either Side
Plug Type	3-Prong (Cord Attached to Unit)
Min. / Max. Water Pressure	20 - 120 psi

INCLUDED ACCESSORIES

Non-Skid Pads, Hole Caps, Wrench, Tie Strap, Elbow Bracket (for Securing Drain Hose)

OPTIONAL ACCESSORIES

Pedestal	WDP6B, WDP6V
Pedestal (W x H x D)	27" x 13 5/8" x 28" (43 7/8" D with door open)
ADA-Compliant Pedestal Riser	WDPS2B
ADA-Compliant Pedestal Riser (W x H x D)	27" x 5 1/8" x 27 1/2"

LG Sidekick™ Pedestal Washer	WD300CB, WD300CV
LG Sidekick™ Pedestal Washer (W x H x D)	27" x 14 1/8" x 30 3/4" (50 1/2" with drawer open)

DIMENSIONS

Product (W x H x D)	27" x 39" x 33 1/8"
Depth with Door Open	57 3/4"
Cutout Dimensions (W x H x D)	29" x 51 1/4" x 37 3/8"
Carton Dimensions (W x H x D)	29 1/8" x 41 7/8" x 33 3/8"
Approx. Weight (Product / Carton)	246.9 / 260.1 lbs

LIMITED WARRANTY

Parts and Labor	1 Year
Direct Drive Motor	10 Years (Parts Only)
Drum	3 Years (Parts Only)

DIMENSIONS / CLEARANCES**FLOOR INSTALLATION**

To ensure sufficient clearance for water inlet hoses, drain hose and airflow, allow minimum clearances of at least 1 inch (2.5 cm) at the sides and 4 inches (10 cm) behind the washer. Be sure to allow for wall, door, or floor moldings that may increase the required clearances.

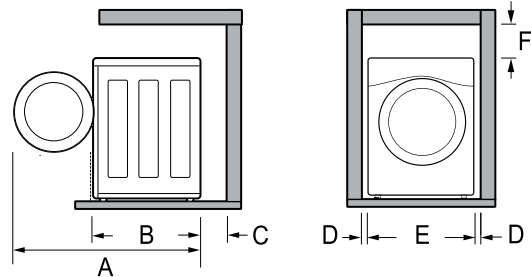
**DIMENSIONS / CLEARANCES**

A	57 3/4" (146.6 cm)
B	33 1/8" (84 cm)
C	4" (10 cm)
D	1" (2.5 cm)
E	27" (70 cm)
F	12 1/4" (31 cm)

PEDESTAL INSTALLATION

The washer can be stacked on top of a pedestal or pedestal washer.

DIMENSIONS / CLEARANCES

A	33 1/8" (84 cm)
B	4" (10 cm)
C	12 1/4" (31 cm)

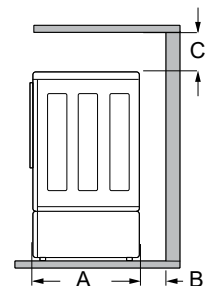

DIMENSIONS / CLEARANCES**SPACING FOR RECESSED AREA OR CLOSET INSTALLATION**

The following clearances are recommended for the appliance.

- Additional clearances should be considered for ease of installation and servicing.
- Additional clearances should be considered on all sides of the dryer to reduce noise transfer.

CLOSET VENTILATION REQUIREMENTS

Closets with doors must have both an upper and lower vent to prevent heat and moisture buildup in the closet. One upper vent opening with a minimum opening of 48 sq. in. (310 cm²) must be installed no lower than 6 feet above the floor. One lower vent opening with a minimum opening of 24 sq. in. (155 cm²) must be installed no more than one foot above the floor. Install vent grilles in the door or cut down the door at the top and bottom to form openings. Louvered doors with equivalent ventilation openings are also acceptable.

- There should be at least a little space around the appliance to eliminate the transfer of vibration from one appliance to another. If there is enough vibration, it could cause appliances to make noise or come into contact, causing paint damage and further increasing noise.
- No other fuel-burning appliance can be installed in the same closet as a dryer.

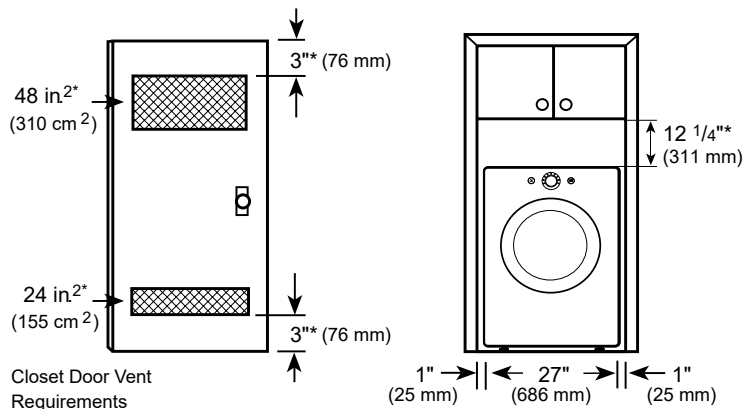

Closet installation with pedestal

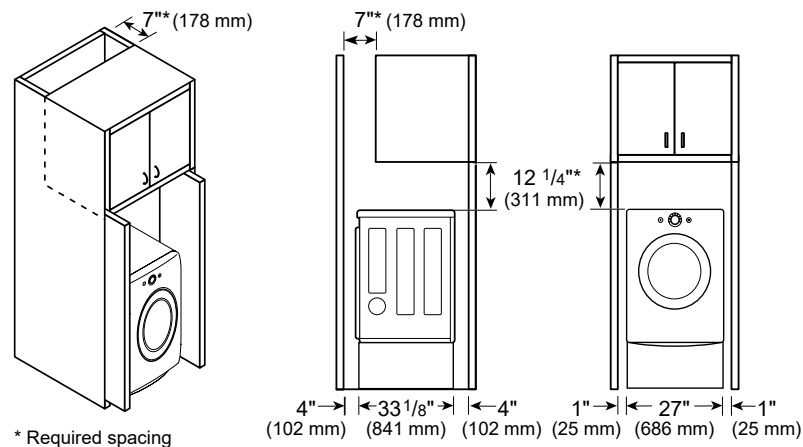

* Required spacing